



**ECO**LIFT 

## 2EWP20-Li 2000kg Heavy-duty Pallet Truck

- Heavy duty truck developed around powerful Li-Ion battery
- Powerful AC vertical drive traction motor
- Small size (l2=470mm) and reduced weight (320kg)
- Stabilizing wheels with new linkage system for maximum stability and traction
- Fast charging through integrated charger
- Ergonomic tiller head with turtle button for operation in narrow spaces
- Cold storage option\*

Electric  
Pallet Truck



## FEATURE

### ■ Ultra-slim design for great maneuverability

The 2EWP20-Li features short chassis length 470mm and small turning radius 1320mm, making it a agile helper in tight spaces and lorries. This compact truck accommodates 2 units in a box compared to 1 unit of the EPT20-20WA, that can reach as high as 50% of ocean freight charges reduction.



### ■ Lithium technology with integrated charger

The 2EWP20-Li comes with 24V/100Ah Li-ion battery and 24V/30A integrated charger as standard, which offers high availability to multi-shift works, thanks to fast and flexible charging and zero maintenance.



### ■ Unique synchronous castor wheels ensuring stability

The optimized castor wheels qualify the 2EWP20-Li for excellent stability and gradeability when handling materials on uneven surfaces and ramps.

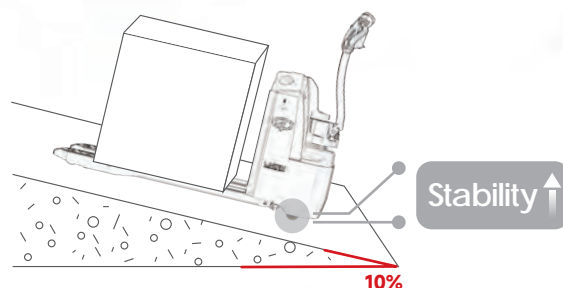

### ■ Reliability enhanced by mature components

The 2EWP20-Li adopts market-proven components with reliability and durability enhanced greatly.



### ■ Keypad option for daily convenience

As an option, the 2EWP20-Li can be fitted with the keypad to replace the key for daily convenience.



## 2EWP20-Li Cold Storage Option

The demand on cold chain transportation is growing dramatically in the fresh food and biochemical industry. Efficient and reliable material handling in cold or freezing environments is of vital importance to guarantee goods turnover. The 2EWP20-Li heavy-duty pallet truck is available in cold stores and freezing chambers as an option, to deal with frozen operation (0 ~ -20°C). The reliability and durability are rigorously tested in low-temperature handling experiments, with its dedicated cold store specifications including water-resistant components, heated Li-ion battery, rubber wheel, cold store oil, etc.



### ■ Waterproof tiller head and electric components

The frequent in and out of cold storage and normal ambient conditions naturally causes condensation and ice crystals on the surface and inside. The waterproof tiller head and other electric and electronic components protect the 2EWP20-Li from water ingress and short circuit for reliable and safe operation.



### ■ Li-ion battery with heating function

In addition to the standard 24V100Ah Li-ion battery with opportunity charging and zero maintenance, the 2EWP20-Li cold storage version has an extra heating function for powering and charging in frozen environments. This heating function enhances performance and minimizes downtime to keep productivity high.



### ■ Rubber wheel and low temperature hydraulic oil

The 2EWP20-Li cold storage version is equipped with rubber wheel, which offers durability and anti-slip performance in cold applications. The low temperature hydraulic oil ensures smooth lifting operation for cold store use at sub-zero temperatures.





# Li-ion pedestrian pallet truck 2.0T

## 2EWP20-Li

|                     |        |   |       |       |                 |
|---------------------|--------|---|-------|-------|-----------------|
| Distinguishing mark | 1.1    | Manufacturer  |       |       | ECOLIFT         |
|                     | 1.2    | Model designation                                   |       |       | 2EWP20-Li       |
|                     | 1.3    | Drive   |       |       | Electric        |
|                     | 1.4    | Operator type                                       |       |       | Pedestrian      |
|                     | 1.5    | Load capacity                                       | Q     | kg    | 2000            |
|                     | 1.6    | Load center distance                                | c     | mm    | 600             |
|                     | 1.8    | Load distance, centre of drive axle to fork         | x     | mm    | 982             |
|                     | 1.9    | Wheelbase   | y     | mm    | 1300            |
| Service weight      | 2.1    | Service weight                                      |       | kg    | 320             |
|                     | 2.2    | Axle loading, laden front/rear                      |       | kg    | 825/1495        |
|                     | 2.3    | Axle loading, unladen front/rear                    |       | kg    | 255/65          |
| Tyres/chassis       | 3.1    | Tyre type   |       |       | PU              |
|                     | 3.2.1  | Tyre size, front                                    |       | mm    | Φ230 x 75       |
|                     | 3.3.1  | Tyre size, rear                                     |       | mm    | Φ80x85          |
|                     | 3.4    | Additional wheels (castor wheels)                   |       | mm    | Φ74x30          |
|                     | 3.5    | Wheels, number front/rear (x=drive wheels)          |       | mm    | 1/2/4           |
|                     | 3.6.1  | Tread width, front                                  | b10   | mm    | 483             |
|                     | 3.7.1  | Tread width, rear                                   | b11   | mm    | 370             |
| Dimensions          | 4.4    | Lift height   | h3    | mm    | 125             |
|                     | 4.9    | Height of tiller handle in drive position min./max. | h14   | mm    | 900/1230        |
|                     | 4.15   | Lowered height                                      | h13   | mm    | 85              |
|                     | 4.19   | Overall length                                      | l1    | mm    | 1620            |
|                     | 4.20   | Length to face of forks                             | l2    | mm    | 470             |
|                     | 4.21   | Overall width                                       | b1/b2 | mm    | 714             |
|                     | 4.22   | Fork dimensions                                     | s/e/l | mm    | 55/170/1150     |
|                     | 4.25   | Distance between fork-arms                          | b5    | mm    | 540/685         |
|                     | 4.32   | Ground clearance, center of wheelbase               | m2    | mm    | 27              |
|                     | 4.34.1 | Aisle width for pallets 1000x1200 crossways         | Ast   | mm    | 2153            |
|                     | 4.34.2 | Aisle width for pallets 800x1200 lengthways         | Ast   | mm    | 2080            |
|                     | 4.35   | Turning radius                                      | Wa    | mm    | 1320            |
| Performance data    | 5.1    | Travel speed, laden/unladen                         |       | km/ h | 5.5/6           |
|                     | 5.2    | Lifting speed, laden/unladen                        |       | m/s   | 0.022           |
|                     | 5.3    | Lowering speed, laden/unladen                       |       | m/s   | 0.039           |
|                     | 5.8    | Max. gradeability, laden/unladen                    |       | %     | 10/16           |
|                     | 5.10   | Service brake                                       |       |       | Electromagnetic |
| Electric-engine     | 6.1    | Drive motor rating S2 60 min                        |       | kW    | 1.6             |
|                     | 6.2    | Lift motor rating at S3 15%                         |       | kW    | 0.8             |
|                     | 6.4    | Battery voltage/nominal capacity                    |       | V/Ah  | 24/100          |
|                     | 6.5    | Battery weight                                      |       | kg    | 44              |
|                     | 6.6    | Energy consumption according to DIN EN 16796        |       | kWh/h | —               |
|                     | 6.7    | Turnover output according to VDI 2198               |       | t/h   | —               |
|                     | 6.8    | Turnover efficiency according to VDI 2198           |       | t/kWh | —               |
| Addition data       | 8.1    | Type of drive control                               |       |       | AC              |
|                     | 10.5   | Steering design                                     |       |       | Mechanical      |
|                     | 10.7   | Sound pressure level at the driver's ear            |       | dB(A) | 74              |
|                     | 15.1   | Charger output current                              |       | A     | 30              |

If there are improvements of technical parameters or configurations, no further notice will be given.  
The diagram shown may contain non-standard configurations.

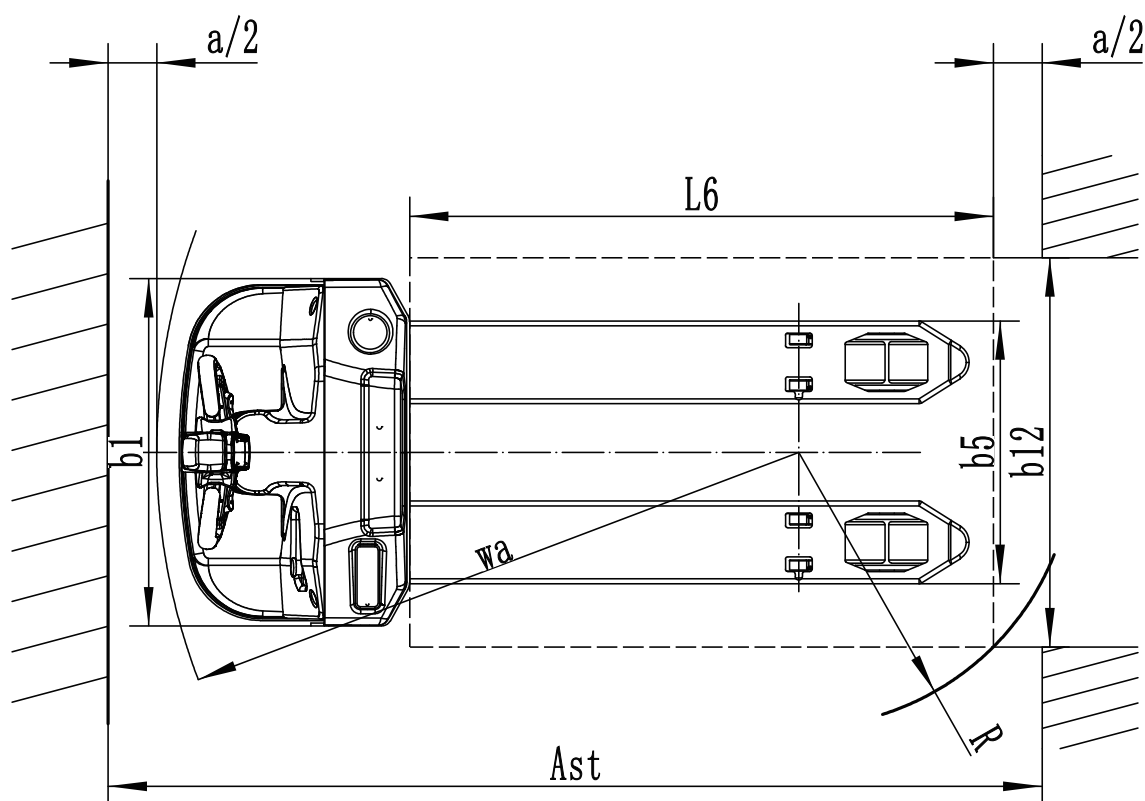
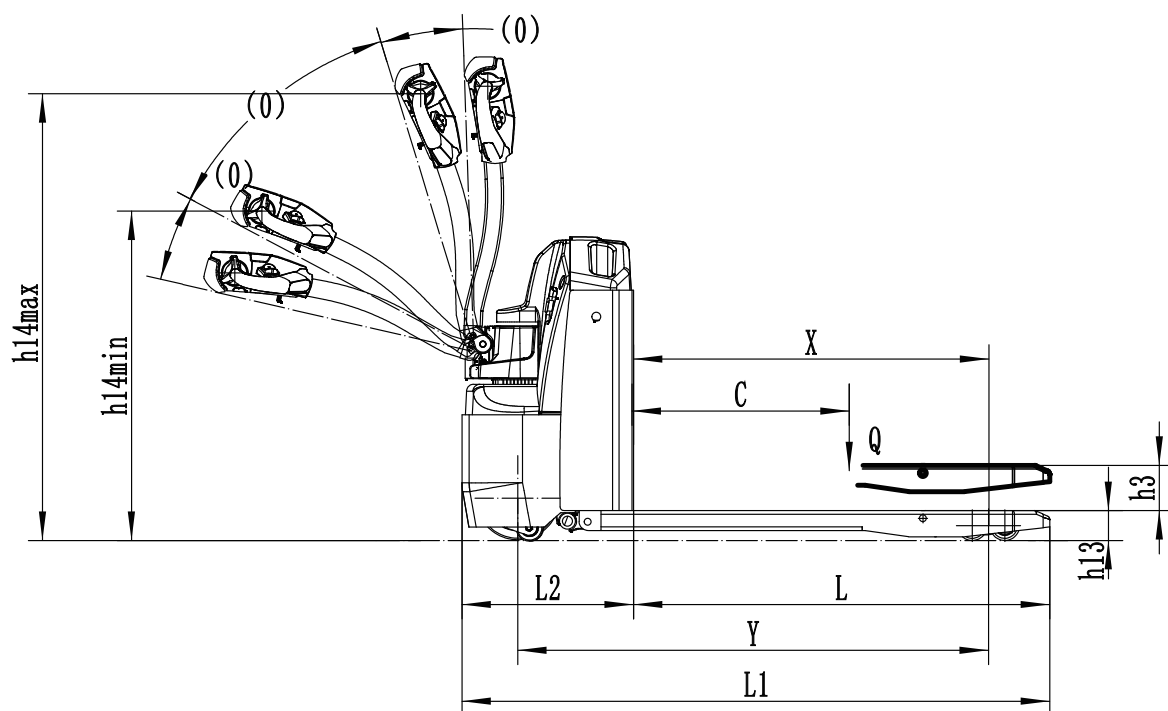

## Option:

| Optional items                                | 2EWP20-Li  |
|---|--|
| Fork dimension                                | ●540*1150○540*850、1000、1220、1300、1450、1600、1800、2000、2400<br>○685*850、1000、1150、1220、1300、1450、1600、1800、2000、2400 |
| Fork lowered height                           | ●85  |
| backrest height                               | ●No○1220mm（48in）○1520mm（60in）  |
| Drive cover off the ground                    | ●35mm  |
| Load wheel type                               | ●Double  |
| Load wheel material                           | ●PU  |
| Drive wheel material                          | ●PU○Trace PU   |
| Battery capacity                              | ●100Ah（Li-ion）   |
| Charger                                       | ●24V-30A Intergrated   |
| Battery indicator                             | ●With hourmeter  |
| Entry roller                                  | ●No  |
| Castor wheels                                 | ●Yes and not customized  |
| Vertical tiller Creep speed                   | ●Yes and not customized  |
| Telematics                                    | ●No○Yes and not customized   |
| The British standard cannot walk when charged | ●No  |
| Pin code                                      | ●No○Yes and not customized   |
| Nota: ●Standard ○ Option -NA                  |  |

| Optional items                                | 2EWP20-Li cold storage   |
|---|--|
| Fork dimension                                | ●540*1150○540*850、1000、1220、1300、1450、1600、1800、2000、2400<br>○685*850、1000、1150、1220、1300、1450、1600、1800、2000、2400 |
| Fork lowered height                           | ●85  |
| backrest height                               | ●No○1220mm（48in）○1520mm（60in）  |
| Drive cover off the ground                    | ●35mm  |
| Load wheel type                               | ●Double  |
| Load wheel material                           | ●PU  |
| Drive wheel material                          | ●Rubber  |
| Battery capacity                              | ●100Ah（Li-ion）   |
| Charger                                       | ●24V-30A In  |
| Battery indicator                             | ●With hourmeter  |
| Entry roller                                  | ●No  |
| Castor wheels                                 | ●Yes and not customized  |
| Pin Code                                      | ●No  |
| Vertical tiller Creep speed                   | ●Yes and not customized  |
| Telematics                                    | ●No○Yes and not customized   |
| The British standard cannot walk when charged | ●No  |
| Cold storage                                  | ●Yes and not customized  |
| Nota: ●standard ○option - NA                  |  |